

CATALOG NUMBER

# ECGB5

## electriCenter

ACCESSORIES

### Ground Bar Kit 5 position, #14-4 AWG

Same As:

- GB5
- EGB5



## GROUND BAR INSTALLATION INSTRUCTIONS



### DANGER

**Hazardous Voltage.**  
Will cause death, serious injury  
or substantial property damage.

Turn off power supplying this  
equipment before working inside.



### SAFETY INSTRUCTIONS

This bag contains one ground bar, self-tapping screw(s) for mounting and one "Equip. Grd." marker.

**Note:** This instruction outlines the recommended installation procedure.

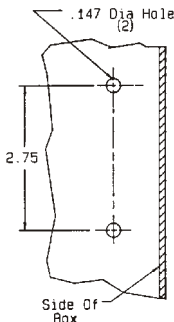

1. Turn off and lock off the power supplying the load center before working inside.

2. Mount grounding bar to back of box where holes are provided using the self-tapping screw(s) enclosed. Torque screws to 24-30 lb-in. The proper holes are located in the side wiring gutter as shown in the diagram.

3. Place "Equip. Grd." marker near the ground bar.

See wiring diagram on device for wire sizes and torques.