

CATALOG NUMBER

ECHV250

electricCenter
ACCESSORIES

2-1/2" HV Hub

Same As:

■ HV250 ■ HV250M



INSTALLATION INSTRUCTIONS



⚠ DANGER

Hazardous Voltage.
Will cause death,
serious injury or substantial
property damage.

Turn off power supplying this
equipment before working inside.

Note: This instruction outlines the recommended installation procedure.

1. Turn off and lock off the power supplying this equipment before working inside.
2. To install, remove gasket and cover plate. Place hub on gasket and secure to endwall using hardware provided. Nuts and lock-washers not required when mounting holes are extruded.
3. Torque screws to 35-45 lb.-in.

⚠ SAFETY INSTRUCTIONS

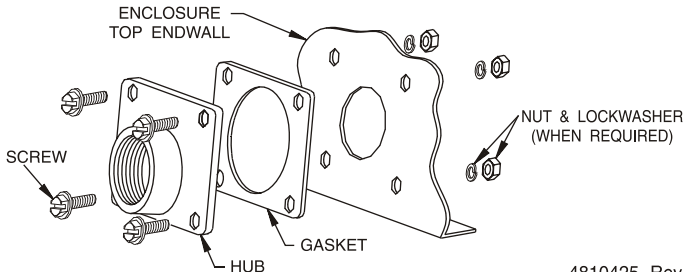

4810425 Rev.A