

CATALOG NUMBER

# ECHV300

**electricCenter**  
ACCESSORIES

## 3" HV Hub

Same As:

■ HV300    ■ HV300M



### INSTALLATION INSTRUCTIONS



#### **⚠ DANGER**

**Hazardous Voltage.**  
Will cause death,  
serious injury or substantial  
property damage.

Turn off power supplying this  
equipment before working inside.



#### SAFETY INSTRUCTIONS

**Note:** This instruction outlines the recommended installation procedure.

1. Turn off and lock off the power supplying this equipment before working inside.
2. To install, remove gasket and cover plate. Place hub on gasket and secure to endwall using hardware provided. Nuts and lock-washers not required when mounting holes are extruded.
3. Torque screws to 35-45 lb.-in.

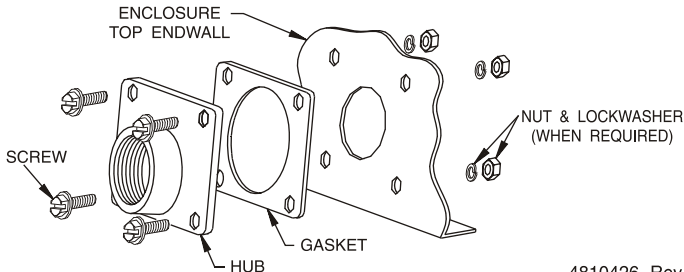

4810426 Rev.A