

DRYCONN®

WATERPROOF CONNECTORS

Filled Connectors for Direct Bury Use



Installation Instructions

IMPORTANT: Turn off power before installing or removing connector.
Product to be used in accordance with local and national codes.

1. Strip wires 5/8" (15.9mm).
2. Align any frayed strands or conductors.
3. Pre-twisting unnecessary. Place stripped wires together with ends of insulation even.
4. Twist connector onto wires pushing firmly until hand-tight. Do not over torque.
5. Wipe sealant in and around conductors and connector opening while tightening. Do not reuse.

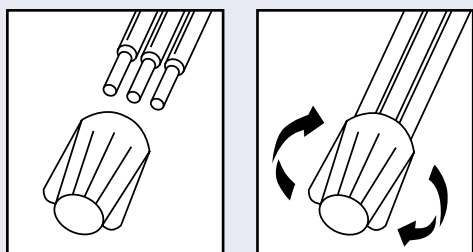

U.S. Pat. 5,113,037 and 5,771,578.
All other trademarks, U.S. & Foreign
Patents Apply. All Rights Reserved.

Selected 600V Wire Combinations

1-3 #10	1 #10 w/1-3 #14	1 #14 w/3-4 #18
1-4 #12	1 #10 w/1-5 #16	2 #14 w/2-4 #16
2-5 #14	1 #12 w/1-4 #14 or #16	1 #8 w/1 #12
4-6 #16	1 #12 w/2-4 #18	5 #14 w/1 #18
3 #14 w/1-2 #16, #18, #20 or #22	2 #12 w/1-2 #14, #16 or #18	1 #8 w/1-2 #16, #18, #20 or #22
3 #12 w/1 #14		

Contact factory for a complete list of wire combinations at 800.633.0232 or www.dryconn.com.

KING
INNOVATION®

DryConn® King 6 Blue

Catalog #	Selling Unit
10600	Card of 2
10666	Bag of 10
10670	Box of 100

PRODUCT SPECIFICATIONS & MEASUREMENTS

Max. Voltage: 600V max. building wire
(1000V max. signs or luminaries)

Connector Size: 2" x 13/16"

Wire Type: Copper/Copper

Wire Range: Min #22/Max #8

Temperature Rating: 105°C (221°F)

Silicone Sealant Temperature: -45°F to 400°F

UL Designation: MDB

Measurements (Inches):

A - 2.00

B - 0.81

C - 0.62

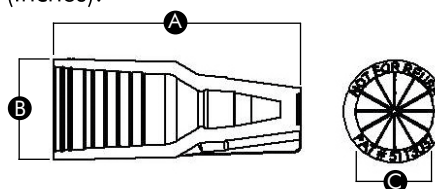

- UL 486D Listed as a sealed wire connector system. For use in damp, wet, raintight, direct bury, and submersible locations. Not to be used in continuous submersion applications.